

THE
POETRY LOVER'S
GARDEN

FIONA CADWALLADER DESIGNS

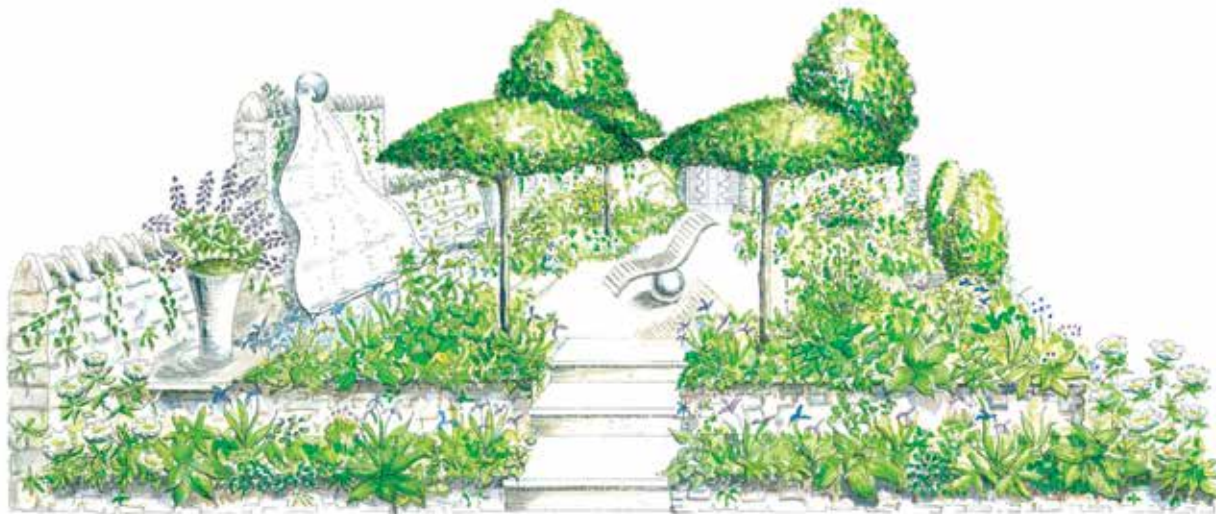

2017 EXHIBITOR

RHS
CHELSEA
FLOWER
SHOW 2017

#RHSCheelsea
STAND AR566



INSPIRATION

The Poetry Lover's Garden presents a tranquil retreat in which to enjoy the pleasures of reading outside in the sunshine near the sound of water. It combines formal structure with relaxed planting using both modern and traditional materials.

Rooftop-pruned lime trees reference the garden's inspiration, Samuel Taylor Coleridge's Romantic poem *This Lime Tree Bower My Prison*. The garden alludes to a world beyond itself while creating a meditative space in which nature, the poem and the imagination come together.

The garden includes references found in the poem, such as ivy-clad dry stone walls, a waterfall represented by a stainless steel water feature, and beanflowers, while polished concrete represents ease, modernity and reflection. A gate into the wildflower-filled orchard to the rear of the garden offers a hint of escape into a less secluded world and the pleasures of human contact. All these elements conjure the uplifting spirituality of the poem's dramatic conclusion, leaving the viewer afloat on the power of the imagination.

This Lime Tree Bower My Prison

SAMUEL TAYLOR COLERIDGE

*(Addressed to Charles Lamb, of the India House,
London)*

*Well, they are gone, and here must I remain,
This lime-tree bower my prison! I have lost
Beauties and feelings, such as would have been
Most sweet to my remembrance even when age
Had dimm'd mine eyes to blindness! They, meanwhile,
Friends, whom I never more may meet again,
On springy heath, along the hill-top edge,
Wander in gladness, and wind down, perchance,
To that still roaring dell, of which I told;
The roaring dell, o'erwooded, narrow, deep,
And only speckled by the mid-day sun;
Where its slim trunk the ash from rock to rock
Flings arching like a bridge;—that branchless ash,
Unsun'd and damp, whose few poor yellow leaves
Ne'er tremble in the gale, yet tremble still,
Fann'd by the water-fall! and there my friends
Behold the dark green file of long lank weeds,
That all at once (a most fantastic sight!)
Still nod and drip beneath the dripping edge
Of the blue clay-stone.*

*Now, my friends emerge
Beneath the wide wide Heaven—and view again
The many-steepled tract magnificent
Of hilly fields and meadows, and the sea,
With some fair bark, perhaps, whose sails light up
The slip of smooth clear blue betwixt two Isles
Of purple shadow! Yes! they wander on
In gladness all; but thou, methinks, most glad,
My gentle-hearted Charles! for thou hast pined
And hunger'd after Nature, many a year,
In the great City pent, winning thy way
With sad yet patient soul, through evil and pain
And strange calamity! Ah! slowly sink
Behind the western ridge, thou glorious Sun!
Shine in the slant beams of the sinking orb,
Ye purple heath-flowers! richlier burn, ye clouds!
Live in the yellow light, ye distant groves!
And kindle, thou blue Ocean! So my friend
Struck with deep joy may stand, as I have stood,
Silent with swimming sense; yea, gazing round
On the wide landscape, gaze till all doth seem
Less gross than bodily; and of such hues
As veil the Almighty Spirit, when yet he makes
Spirits perceive his presence.*

*A delight
Comes sudden on my heart, and I am glad
As I myself were there! Nor in this bower,
This little lime-tree bower, have I not mark'd
Much that has sooth'd me. Pale beneath the blaze
Hung the transparent foliage; and I watch'd
Some broad and sunny leaf, and lov'd to see
The shadow of the leaf and stem above
Dappling its sunshine! And that walnut-tree
Was richly ting'd, and a deep radiance lay
Full on the ancient ivy, which usurps
Those fronting elms, and now, with blackest mass
Makes their dark branches gleam a lighter hue
Through the late twilight: and though now the bat
Wheels silent by, and not a swallow twitters,
Yet still the solitary humble-bee
Sings in the bean-flower! Henceforth I shall know
That Nature ne'er deserts the wise and pure;
No plot so narrow, be but Nature there,
No waste so vacant, but may well employ
Each faculty of sense, and keep the heart
Awake to Love and Beauty! and sometimes
'Tis well to be bereft of promis'd good,
That we may lift the soul, and contemplate
With lively joy the joys we cannot share.
My gentle-hearted Charles! when the last rook
Beat its straight path along the dusky air
Homewards, I blest it! deeming its black wing
(Now a dim speck, now vanishing in light)
Had cross'd the mighty Orb's dilated glory,
While thou stood'st gazing; or, when all was still,
Flew creaking o'er thy head, and had a charm
For thee, my gentle-hearted Charles, to whom
No sound is dissonant which tells of Life.*

Fiona Cadwallader is a designer and artist specialising in gardens and domestic interiors. Fiona left Cambridge University to pursue a career in art and design and worked at a number of leading architectural practices in London. She taught at Chelsea College of Art & Design while building up her private practice.

Fiona studied at The English Gardening School and offers a full design service, working with a team of reliable contractors and suppliers.

As part of the National Garden Scheme Fiona opens her garden, Watergate House, to the public and also lectures regularly to garden societies across Kent. She has a specific interest in historical gardens. Her own garden has been featured in *The English Garden* and *Country Homes and Interiors*.

www.cadwallader.co.uk



FIONA CADWALLADER

PLANT LIST



Ajuga 'Black Scallop'



Alchemilla mollis



Amsonia tabernaemontana
var. salicifolia



Astrantia major 'Star of Billion'



Bearded Iris 'Sable'



Bearded Iris 'Jurassic Park'



Brunnera macrophylla 'Jack Frost'



Curled parsley



Galium odoratum



Geranium 'Mrs Kendall Clark'



Geranium phaeum 'Lily Lovell'



Geum 'Lemon Drops'



Hosta 'Devon Green'



Pittosporum tenuifolium
'Irene Paterson'



Pulmonaria 'Majeste'



Ranunculus acris



Selaginella kraussiana



Silene fimbriata



Anchusa azurea 'Loddon Royalist'



Anthriscus sylvestris



Asarum europaeum



Asplenium trichomanes



Digitalis purpurea f. albiflora



Euphorbia x pasteurii



Fragaria vesca



Fritillaria persica 'Twin Towers'



Hosta undulata var. univittata



Leucanthemum vulgare



Paeonia lactiflora 'Jan van Leeuwen'



Philadelphus 'Belle Etoile'



Tellima grandiflora



Tilia europaea 'Euchlora'



Trollius x cultorum 'Cheddar'



Viola labradorica

OTHER FEATURED PLANTS

Alchemilla hoppeana
Asplenium scolopendrium
Briza media
Broad beans
Cymbalaria muralis
Epimedium x youngianum 'Niveum'
Foeniculum vulgare 'Purpureum'
Hedera helix 'Sagittifolia'
Iris sibirica 'Papillon'
Kirengeshoma palmata
Libertia grandiflora
Melica altissima 'Alba'
Myosotis arvensis
Peony 'Shirley Temple'
Phlox divaricata
'Clouds of Perfume'
Pulmonaria 'Opal'
Pyrus 'Weinbirne'
Silene vulgaris
Thalictrum 'Black Stockings'
Trollius x cultorum 'Lemon Queen'
Waldsteinia ternata



#CFSpoet

GET LYRICAL AT CHELSEA!

Gardens have inspired great poems throughout history, from Homer's *Garden of Alcinous* to Milton's *Paradise Lost*, through to Elizabeth Jennings's *In a Garden*.



It was a poem by Samuel Taylor Coleridge, *This Lime Tree Bower My Prison*, which provided the inspiration for Fiona Cadwallader's Artisan Garden at RHS Chelsea Flower Show 2017.

Why not create a short 'Micro-Poem' about *The Poetry Lover's Garden*, or any of the incredible floral delights here at RHS Chelsea Flower Show (CFS), or share a short verse from a garden-inspired poem that you love.

Please post these on Twitter, Facebook or Instagram using the hashtag **#CFSpoet** so we can bring all your poems together.

Your 'Micro-Poems' can also be submitted via a pen and paper, here on *The Poetry Lover's Garden* in our special *Poem Pot* at the side of the garden.

Each day Fiona will select her **#CFSpoet of the Day** from all the entries and will post her favourite on her Facebook or Twitter pages **@FMCadwallader**

 www.facebook.com/FMCadwallader
 [@FMCadwallader](https://twitter.com/FMCadwallader)
 www.instagram.com/fionacadwallader

Fiona Cadwallader Designs
Watergate House
Fordwich
Near Canterbury
Kent CT2 0DB

T 01227 710470
M 07990 971375
W www.cadwallader.co.uk
E fiona@cadwallader.co.uk



THANK YOU TO...

Jacques Amand Intl
Jane Southcott pr
Hode Pottery
Kelways
Landform Consultants Ltd
Lindum Turf
Lovell Stone Group
Peter Beales Roses Ltd
Outdoor Design
Van den Berk Nurseries

PHOTO CREDITS

Tilia europaea
© The Garden Collection
All other plant photographs
© Kelways or Fiona Cadwallader
Portrait of Fiona © Patrick Heren